

E-Z TRAIL CF-890 CARRIER FEEDER

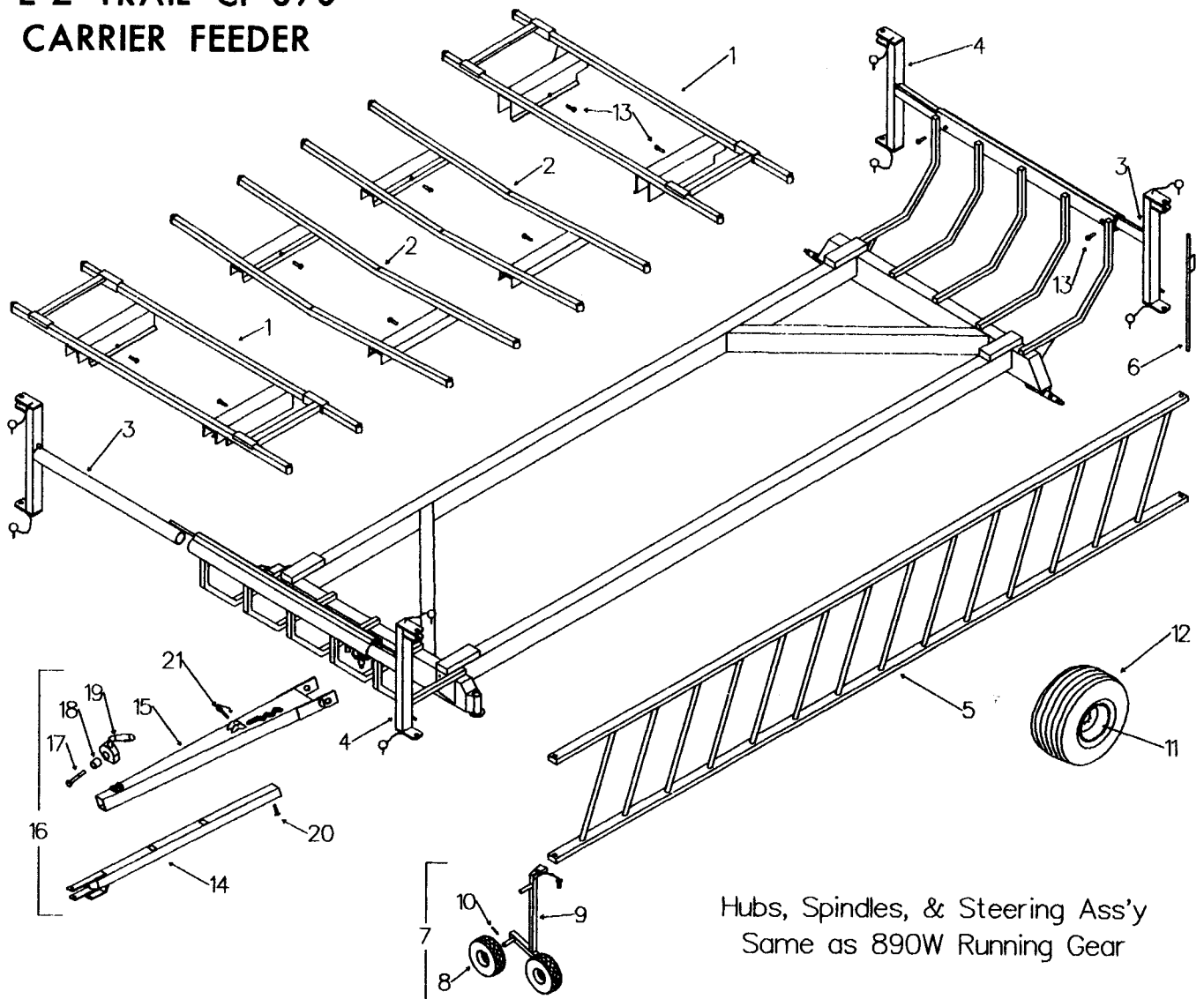

Hubs, Spindles, & Steering Ass'y
Same as 890W Running Gear

#	Part#	Qty.	Description
1	8931	2	End Cradle
2	8932	2	Center Cradle
3	8935	2	Inner T-Bar
4	8936	2	Outer T-Bar
5	8937	2	Feeder Panel
6	8938	4	Panel Rod
7	8940	1	Dolly Wheel Ass'y
8	8941	2	4.10/3.50-4 Tire & Wheel
9	8942	1	Dolly Frame
10		2	5/32 x 1 Cotter Pin
11	8912	4	12 x 10.5 Wheel
12	8926	4	26 x 12.00-12 Tire
13		12	1/2 x 1-1/4 Set Screw
14	8962	1	Tongue Inner
15	8961	1	Tounge Outer
16	8963	1	Tongue Ass'y
17	606	1	7/16-20 x 2 Bolt
18	607	1	Cam Latch Bushing
19	609	1	Cam Latch
20	1562	1	3/4-10 x 1 Bolt
21	8966	1	Locking Pin

MODEL CF-890 BALE CARRIER/FEEDER SET-UP & OPERATING INSTRUCTIONS

1. Check wheel bearings for lubrication & proper adjustment: approx. 5 ft-lbs. of pre-load torque. Attach wheels with valve stems towards inside. 60 to 65 PSI is recommended for the special 26 x 12.00 tires.
2. Space the bale cradles wherever they best fit your size or diameter of bales. Four cradles are provided to accommodate up to eight 5' bales. Six 6' Bales can be loaded without removing the fourth cradle by placing the center two bales between cradles.
3. Attach the slant bar feeder panels with the two rods provided. The panels could hinge from either end but for safety reasons we recommend to hinge at the front and swing open at the rear. The feeder panels are not pinned the same at both ends, the end that swings open fits between the rod and the attaching post, thus permitting one end to feed faster or advance ahead of the other.
4. The four corner chains are necessary to keep calves out of the feeder when it is partially empty. Properly adjusted the chains will permit the panels to make their maximum stroke in and out. Too much slack, however, would let the chain sag and rub on the tire.
5. A dolly wheel assembly is provided to attach to the lower rail for opening the feeder panel. Caution: Grip the panel firmly with both hands. The panel may flip over when it is half open or parallel with the slider tube.
6. The E-Z Hitch tongue is adjustable in length. The long position will permit carrying an extra bale on the 3 point hitch of the towing tractor. The tongue can be pinned up in raised position while feeding to keep it clean and from freezing to the ground. Always practice safety first, use proper lighting and safe speeds if used on public roads.

Hopefully wintertime feeding will be more enjoyable and profitable by saving labor and feed costs. Any comments or suggestions that would enhance the performance are always welcome.