

# E-Z Trail 916 & 918 Bale Throw Racks

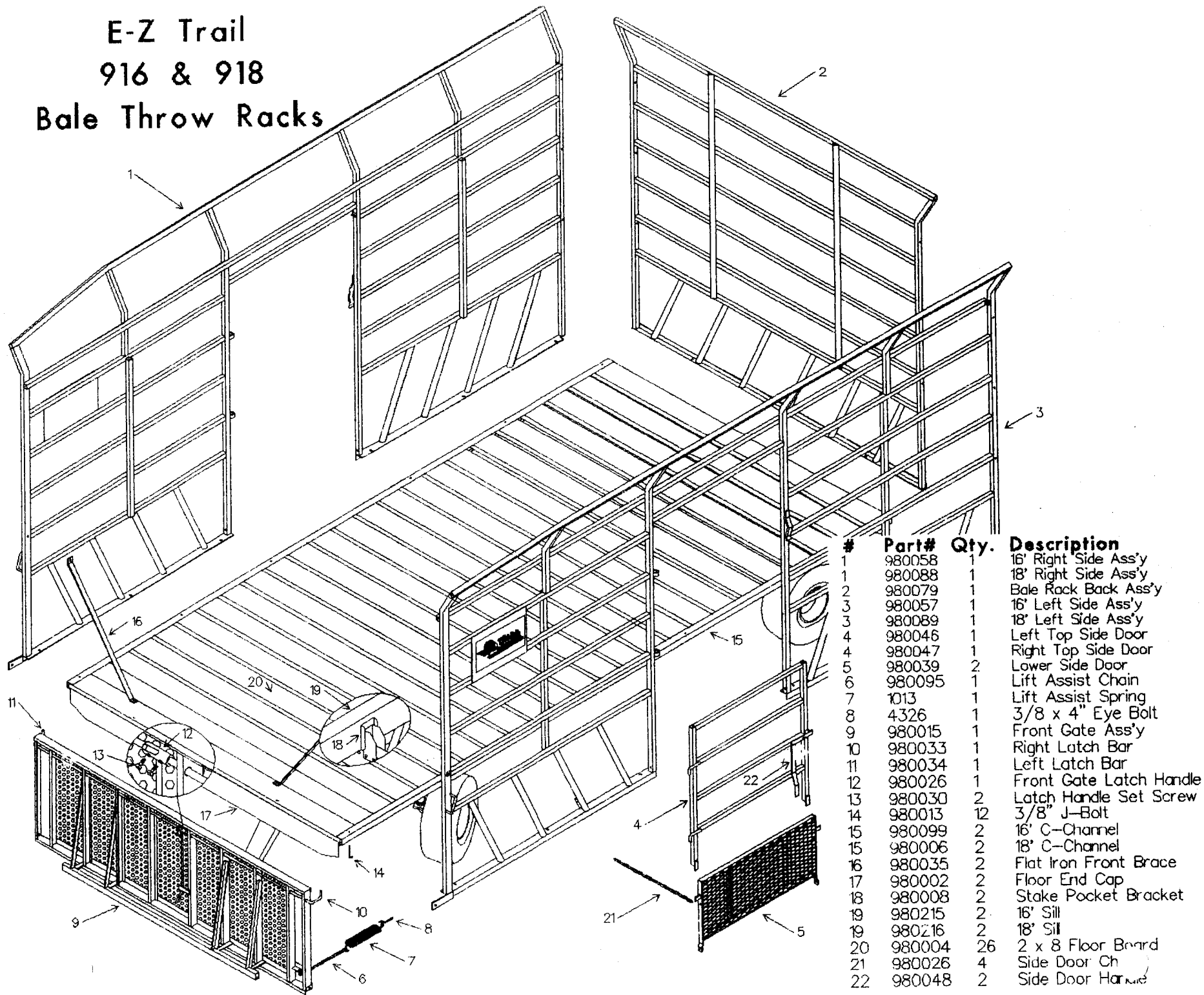

#	Part#	Qty.	Description
1	980058	1	16' Right Side Ass'y
1	980088	1	18' Right Side Ass'y
2	980079	1	Bale Rack Back Ass'y
3	980057	1	16' Left Side Ass'y
3	980089	1	18' Left Side Ass'y
4	980046	1	Left Top Side Door
4	980047	1	Right Top Side Door
5	980039	2	Lower Side Door
6	980095	1	Lift Assist Chain
7	1013	1	Lift Assist Spring
8	4326	1	3/8 x 4" Eye Bolt
9	980015	1	Front Gate Ass'y
10	980033	1	Right Latch Bar
11	980034	1	Left Latch Bar
12	980026	1	Front Gate Latch Handle
13	980030	2	Latch Handle Set Screw
14	980013	12	3/8" J-Bolt
15	980099	2	16' C-Channel
15	980006	2	18' C-Channel
16	980035	2	Flat Iron Front Brace
17	980002	2	Floor End Cap
18	980008	2	Stake Pocket Bracket
19	980215	2	16' Sill
19	980216	2	18' Sill
20	980004	26	2 x 8 Floor Board
21	980026	4	Side Door Ch
22	980048	2	Side Door Handle



### Set-up Instructions for E-Z Trail Bale Throw Racks

1. Adjust running gear to desired wheelbase. We recommend no more than 13' for 18' racks and 12' for 16' racks. Set stake pockets on gear to 42" wide.
2. Set bale rack floor on running gear, bolt the sills to the front stakes with the existing 1/2" carriage bolt thru the stake pocket bracket. The sills set between the rear stake pockets and are not bolted.
3. Remove the flange nuts from the j-bolts on the side of the floor. Set the sides on the edge of the floor, and reinstall the flange nuts.
4. Fasten the bale rack back to the sides using **6 – 3/8 x 3 Bolts**. Use **2 – 3/8 x 2-1/2 bolts** to fasten the back to the floor.
5. Fasten the flat iron braces to the front of the sides using **2 – 3/8 x 2-1/4 bolts**. Use **2 – 3/8 x 2-1/2 bolts** to fasten the braces to the floor.
6. Install the front gate with **2 – 1/2 x 1 1/2 bolts with locknuts**. Attach the lift assist chain to the front gate using a **3/8 x 1 flange bolt**, fasten the **3/8 x 4 eyebolt** to the bracket on the left side. Hook the lift assist spring to the eyebolt and the chain, adjust to take the slack out of the chain when the gate is closed.